

Continental C-2500 Series

| Item | Description |
|-------------|-------------------------|
| 25-01 | Upper Body |
| 41-02 | Lower Body (14 Outlet) |
| 41-03 | Lower Body (1" FPT) |
| 01-04 | Rope Rull Casting |
| 65-11B | Adjusting Screw |
| 65-13 | Cam Rod |
| 01-14 | Lock Nut (2) |
| 41-15 | Stem |
| 65-18 | 1" Half Union |
| 65-19 | Union Nut |
| 65-20 | Ratchet Cam |
| 01-21 | Ratchet Pawl |
| 01-22 | Cam Housing |
| A-41-24 | Bonnet Assembly |
| 41-26 | Spring Retainer Plug |
| 01-30B | Cam Housing Cap |
| 01-30DS | Drive Screw (2) |
| 01-31 | Packing Retainer |
| 65-33B | Cap Seal Retainer |
| 65-34 | Lower Stem |
| 65-35 | Throttle Seat |
| A-65-37 | Seat Assembly |
| 25-39 | Meter Barrel |
| A-41-41 | Filter Pull Assembly |
| 41-53 | Orifice Seat Insert |
| 01-60F | Teflon Packing (2) |
| 01-64F | Rope </td |
| 01-70F | O-ring Stem Seal |
| 01-71BF | Cap Seal (Meter Barrel) |
| 65-71BF | Cap Seal (Bonnet) |
| 41-72 | Diaphragm |
| 01-73 | O-ring Seal |
| 65-75 | Retainer Washer |
| 01-80 | Upper Diaphragm Plate |
| 65-81 | Lower Diaphragm Plate |
| A-25-82BF | Dial Assembly |
| 41-83FX | Strainer Screen |
| 41-84F | Spring Bracket |
| 01-85F | Indicator Flag |
| 01-86F | Ratchet Stop Plate |
| 01-87 | Rope Guide Washer |
| 01-88 | Retainer Washer |
| 01-89 | Dial Tension Washer (2) |
| 65-90 | Meter Spring |
| 65-91 | Shut Off Spring |
| 01-92 | Return Spring |
| 01-92BF | Dial Lock Pin |
| 01-93 | Pawl Spring |
| 01-94F | Flag Lock Pin |
| 01-95 | Cam Rod Spring |
| 01-97 | Rope Guide |
| 01-832-25 | Dial Set Screw |
| 01-2520-100 | Body Cap Screw |
| 01-2520-125 | Body Cap Screw (4) |
| 01-2520-25 | Spring Retainer Screw |

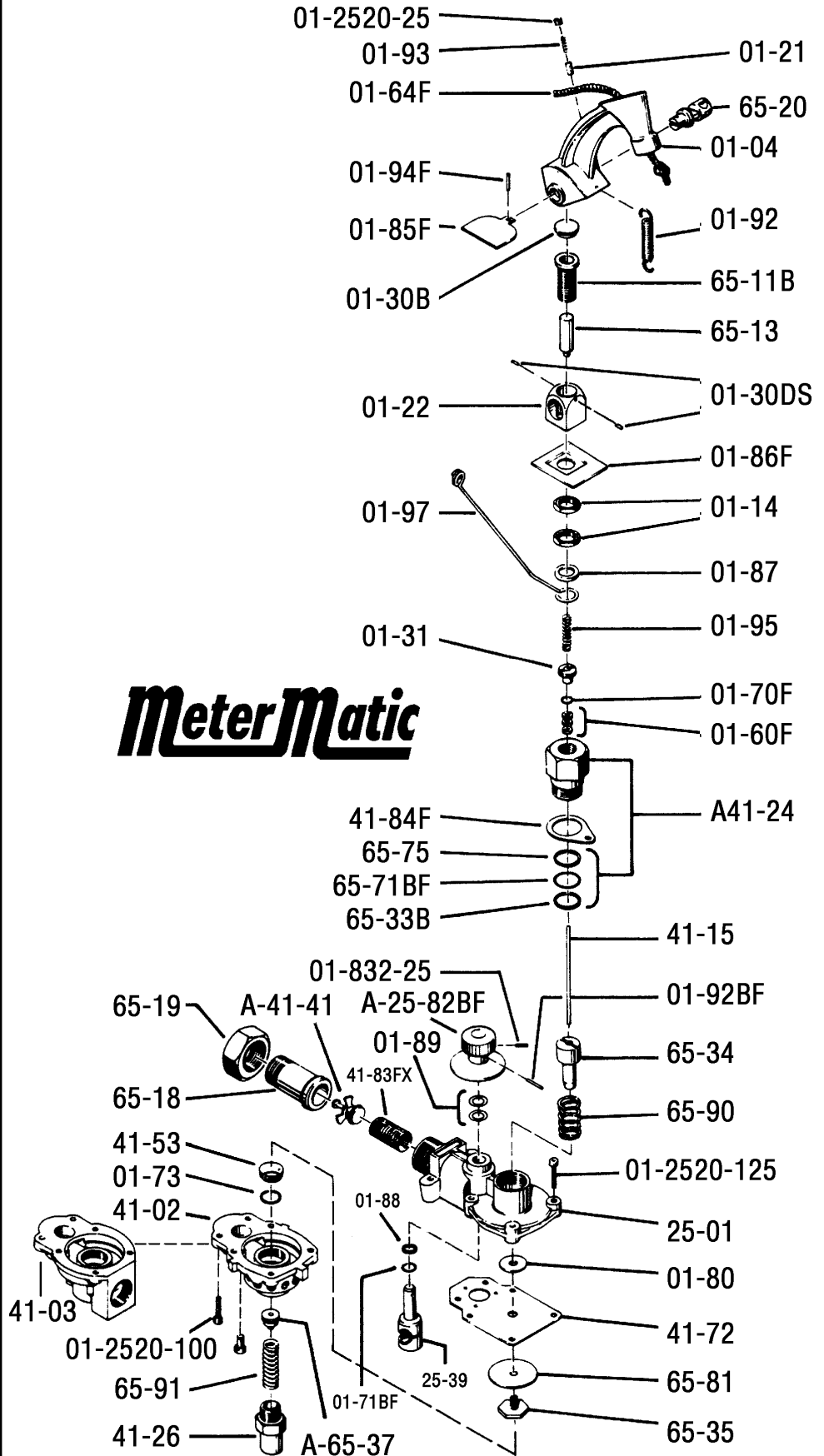

*25-39 & 25-82BF Available only at factory