

Continental C-4100 Series

Item	Description
A41-01	Upper Body Assembly w/ Meter Barrel & Dial
41-02A	Lower Body - 14 Outlet
41-03A	Lower Body - 1" FPT Outlet
01-04	Lever, Rope Pull Casing
65-11B	Adjusting Screw
65-13	Cam Rod
01-14	Lock Nut (2)
41-15	Stem
65-17	Union Nut
65-19	1" Half Union
65-20	Ratchet Cam
01-21	Ratchet Pawl
01-22	Cam Housing
A-41-24	Bonnet Assembly
41-26	Spring Retainer Plug
01-30B	Cam Housing Cap
01-30DS	Drive Screws (2)
01-31	Packing Retainer
65-33B	Cap Seal Retainer
65-34	Lower Stem
65-35	Throttle Seat
A-65-37	Seat Assembly
41-39	Meter Barrel
A-41-41	Filter Pull Assembly
41-53	Orifice Seat Insert
01-60F	Teflon Packing (set)
01-64F	Rope </td
01-70F	O-ring Stem Seal
65-71BF	Cap Seal (Meter Barrel)
41-72	Diaphragm
01-73	O-ring Seal
65-75	Retainer Washer
01-80	Upper Diaphragm Plate
65-81	Lower Diaphragm Plate
A-41-82BF	Dial Assembly
41-83FX	Strainer Screen
41-84F	Spring Bracket
01-85F	Indicator Flag
01-86F	Ratchet Stop Plate
01-87	Rope Guide Washer
01-88	Retainer Washer
01-89	Dial Tension Washer
65-90	Meter Spring
65-91	Shut Off Spring
01-92	Return Spring
01-92BF	Dial Lock Pin
01-93	Pawl Spring
01-94F	Flag Lock Pin
01-95	Cam Rod Spring
01-97	Rope Guide
01-832-25	Dial Set Screw
01-2520-100	Body Cap Screw
01-2520-125	Body Cap Screw (4)
01-3118-25	Spring Retainer Screw

MeterMatic

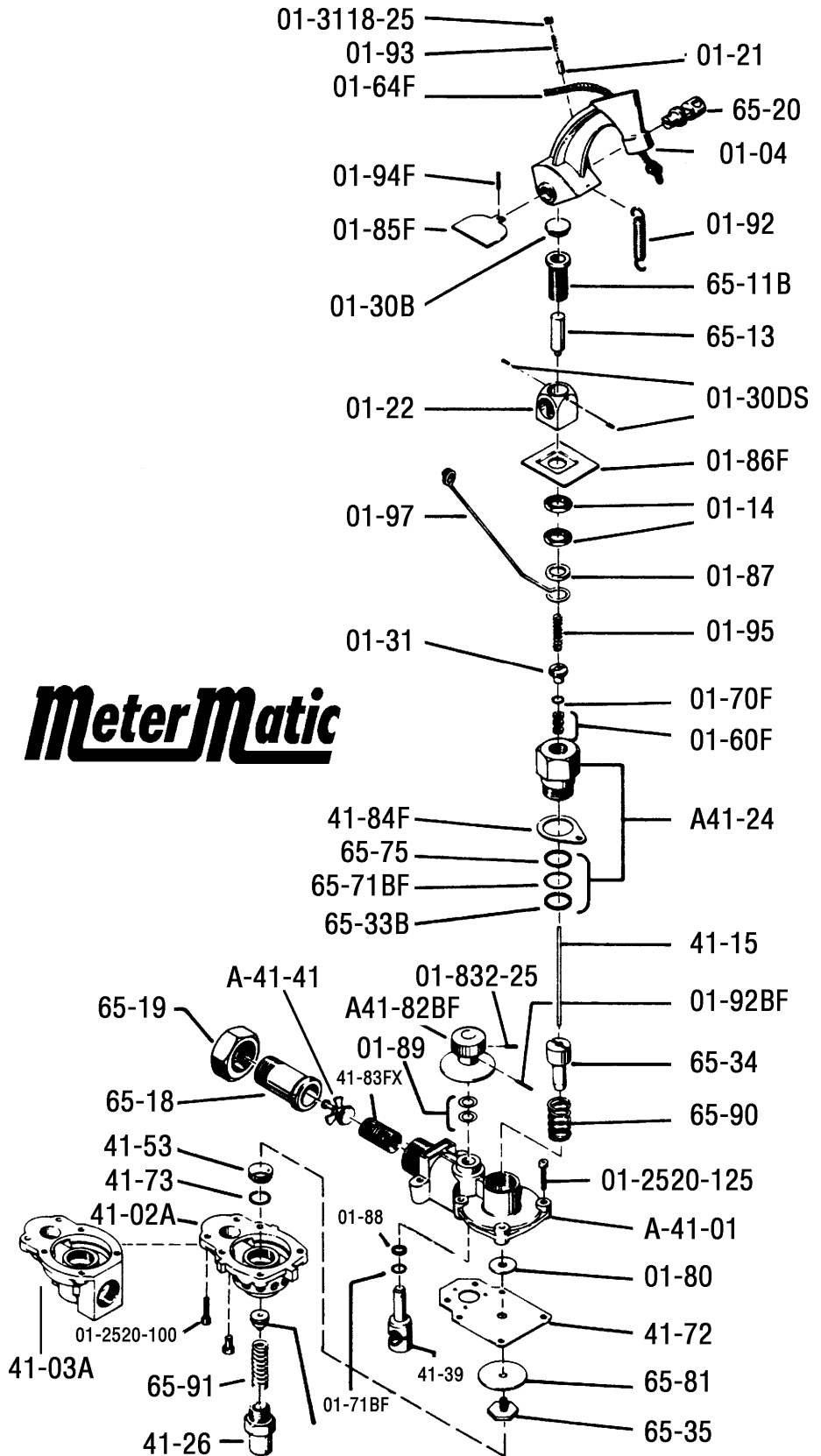

*41-39 & A41-82BF Available only at factory