

6, 7 & 8 Roller Pumps

MAX RECOMMENDED PRESSURE: 300 psig(2000 kPa) • MAX. RECOMMENDED TEMP: 120°F (50°C)
 • MAX. RECOMMENDED PTO SPEED: 850 RPM (for models 77-5110, 77-5130, 77-6110 and 77-6130)
 1000 RPM (for models 66-5110, 88-5110 and 88-6110)

Model Number System	77-	5	1	1	0
PORTING:					
6-	6 Roller Side Port				
66-	6 Roller Back-Port				
77-	7 Roller Side Port				
88-	8 Roller Side Port				
CONSTRUCTION:					
5-	Cast Iron, 11/16" roller design				
6-	Ni-Resist, 11/16" roller design				
ROLLERS:					
1-	Polypropylene				
SEALS:					
1-	Viton-A				
3-	Teflon (avail. on 7-Roller Pump)				
ROTATION:					
0-	Standard				
1-	Reverse				

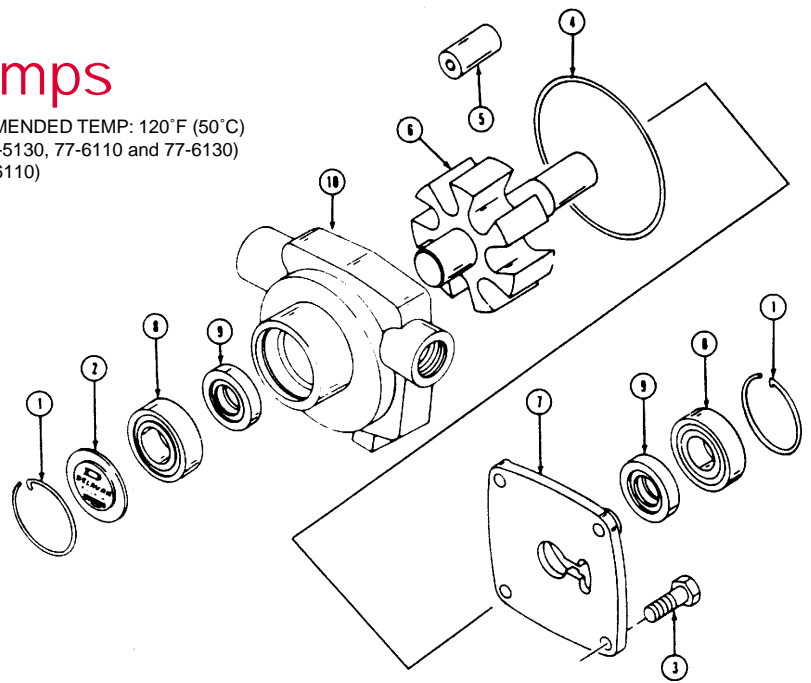

DEHAVAN®

Ref. No.	Part No.	Description	Quantity Required										
			6-5110	6-5111	66-5110	77-5110	77-5111	77-5130	77-6110	77-6111	77-6130	88-5110	88-6110
1	15070	Snap Ring	2	2	2	-	-	-	-	-	-	-	-
	15334	Snap Ring	-	-	-	2	2	2	2	2	2	2	2
2	46210	Nameplate	1	1	1	-	-	-	-	-	-	-	-
	46209	Nameplate	-	-	-	1	1	1	1	1	1	1	1
3	15077	Capscrew	4	4	4	-	-	-	-	-	-	-	-
	15341	Capscrew	-	-	-	4	4	4	4	4	4	4	4
4	24819	Seal Ring	1	1	1	-	-	-	-	-	-	-	-
	24829	Seal Ring	-	-	-	1	1	1	1	1	1	1	1
5	19341	Roller, Polypropylene 11/16"	6	6	6	7	7	7	7	7	7	7	7
6	31661-8	Stainless Steel Shaft/Powdered Metal Rotor Assy.	1	1	1	-	-	-	-	-	-	-	-
	31661-10	SS Shaft/Pow. Metal Rotor Assy.	-	-	-	1	1	1	-	-	-	-	-
	31661-11	SS Shaft/Stainless Steel Rotor Assy.	-	-	-	-	-	-	1	1	1	-	-
	31661-12	SS Shaft/Pow. Metal Rotor Assy.	-	-	-	-	-	-	-	-	-	1	-
	31661-13	SS Shaft/SS Rotor Assy.	-	-	-	-	-	-	-	-	-	-	1
7	31664-1	End Plate, Cast Iron	1	1	1	-	-	-	-	-	-	-	-
	31666-1	End Plate, Cast Iron	-	-	-	1	1	1	-	-	-	1	-
	31666-2	End Plate, Ni-Resist	-	-	-	-	-	-	1	1	1	-	1
8	15072	Ball Bearing (Std. Brg. #6203ZZ)	2	2	2	-	-	-	-	-	-	-	-
	16228	Ball Bearing (Std. Brg. #6205ZZ)	-	-	-	2	2	2	2	2	2	2	2
9	20468	Lip Seal, Viton	-	-	-	-	-	-	-	-	-	-	-
	20469	Lip Seal, Viton	-	-	-	2	2	-	2	2	-	2	2
	25230	Lip Seal, Teflon	-	-	-	-	-	2	-	-	2	-	-
	50047	Lip Seal, Teflon	2	2	2	-	-	-	-	-	-	-	-
10	24817	Pump Body, Cast Iron	-	-	1	-	-	-	-	-	-	-	-
	24842-1	Pump Body, Cast Iron	-	-	-	1	1	1	-	-	-	-	-
	24842-2	Pump Body, Ni-Resist	-	-	-	-	-	-	1	1	1	-	-
	24842-3	Pump Body, Cast Iron	-	-	-	-	-	-	-	-	-	1	-
	24842-4	Pump Body, Ni-Resist	-	-	-	-	-	-	-	-	-	-	1
	50073-1	Pump Body, Cast Iron	1	1	-	-	-	-	-	-	-	-	-

Pump Repair Kits

Roller Pump Repair Kits Part Lis

Part No.	To Repair These Pumps	Description	Part No.	Description	Qty. Req'd for these Repair Kits			
					48394-1	48394-2	48394-3	48394-4
48394-1	Delavan 66-5510, 6-5510, 6-5111	Six 11/16" rollers, Viton Seals	19341	Roller, Poly., 11/16"	6	7	8	7
			20469	Shaft Seal, Viton-A	-	2	2	-
48394-2	Delavan 77-5110, 77-5111, 77-6110, 77-6111	Seven 11/16" rollers, Viton Seals	20468	Shaft Seal, Viton-A	2	-	-	-
			25203	Shaft Seal, Teflon	-	-	-	2
48394-3	Delavan 88-5110, 88-6610	Eight 11/16" rollers, Viton Seals	24829	Seal Ring	-	1	1	1
48394-4	Delavan 77-5130, 77-6130	Seven 11/16" Teflon Seals	24819	Seal Ring	1	-	-	-