

FILL-RITE

Owner's Operation & Safety Manual
Manuel d'utilisation et de sécurité
Manual de operación y seguridad
Bedienungsanleitung und Sicherheitsvorschriften

SERIES FR4200 & FR4400 PUMPS **POMPES DE LA SÉRIE FR4200 & FR4400** **BOMBAS SERIE FR4200 & FR4400** **PUMPEN SERIE FR4200 & FR4400**

For models: FR4210, FR4211, FR4410, FR4411

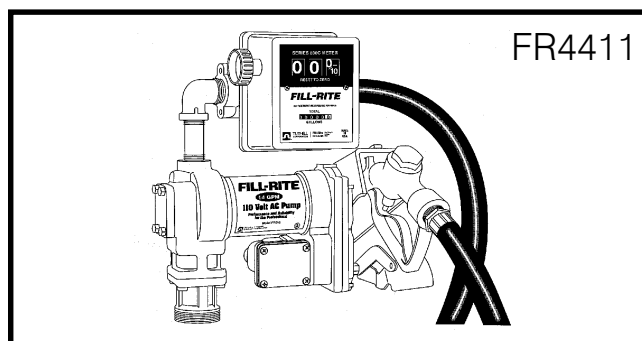
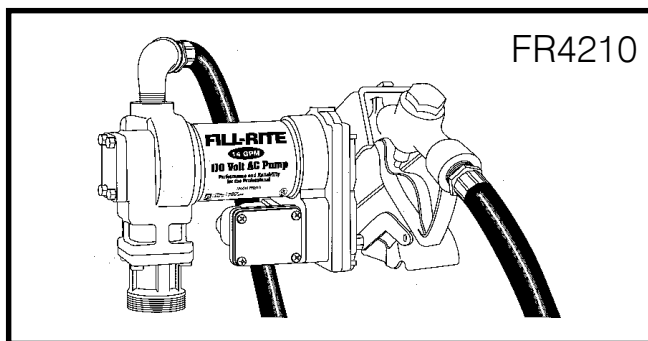

OUTSTANDING FEATURES • CARACTÉRISTIQUES EXCEPTIONNELLES **CARACTERÍSTICAS PRINCIPALES • BESONDERE MERKMALE**

- Up to 20 GPM / 76 LPM
- UL and C-UL listed pump and motor (FR4200 series only)
- Full 1/4 HP 12 VDC-22 amp motor
- Optional 24 VDC-13 amp motor
- Thermal overload protector
- Integral check valve/thermal relief valve
- Built-in bypass valve
- Sealed ball bearings
- Machined carbon vanes

- Jusqu'à 76 l/min (20 gal/min)
- Moteur et pompe homologués UL et C-UL (série FR4200 uniquement)
- Moteur 1/4 CV 12 V cc -22 A
- Moteur optionnel de 24 V cc - 13 A
- Disjoncteur thermique
- Clapet anti-retour/clapet de décharge thermique intégré
- Soupape de dérivation intégrée
- Roulements à billes scellés
- Pales en carbone usiné

- Hasta 20 GPM / 76 LPM
- Bomba y motor listados por UL y C-UL (Serie FR4200 únicamente)
- Motor de 1/4 HP 12 VCD -22 amperios
- Motor opcional de 24 VCD - 13 amperios
- Protector contra sobrecarga térmica
- Válvula de retención integrada/válvula de alivio térmico
- Válvula de desvío integral
- Cojinetes de bola herméticos
- Paletas de carbón trabajadas a máquina

- Bis zu 76 l/min (20 Gal/min)
- Pumpe und Motor UL- und C-UL-normiert (Nur Serie FR4200)
- 0,25 PS, 12V, 22A Motor
- 24V, 13A-Motor auf Bestellung
- Thermischer Überlastschutz
- Eingebautes Rückschlag-/Thermostventil
- Eingebautes Sicherheitsventil
- Abgedichtete Kugellager
- Bearbeitete Kohlenstoffschieber

SERIES FR4200\FR4400 PUMP PARTS LIST
NOMENCLATURE DE POMPE DES SÉRIES FR4200/FR4400
LISTA DE PIEZAS DE LA BOMBA SERIE FR4200/FR4400
ERSATZTEILLISTE FÜR PUMPEN SERIE FR4200\FR4400

■
 WHEN ORDERING REPAIR PARTS, BE SURE TO GIVE REPLACEMENT PART NUMBER, DATE OF MANUFACTURE AND PUMP SERIES NUMBER. THIS WILL ENSURE THAT THE CORRECT REPLACEMENT PART IS SUPPLIED.

TOLL FREE CUSTOMER CARE NUMBER
 800 634 2695

▲
 LORS DE LA COMMANDE DE PIÈCES DE RECHANGE, ASSUREZ-VOUS DE FOURNIR LA RÉFÉRENCE DE LA PIÈCE DE RECHANGE, LA DATE DE FABRICATION ET LE NUMÉRO DE SÉRIE DE LA POMPE. CECI ASSURE QUE LA BONNE PIÈCE DE RECHANGE EST FOURNIE..

●
 CUANDO ORDENE PIEZAS PARA REPARACIÓN, ASEGÚRESE DE DAR EL NÚMERO DE PIEZA DE REPUESTO, LA FECHA DE FABRICACIÓN Y EL NÚMERO DE LA SERIE DEL MEDIDOR. ESTO GARANTIZA QUE LA PIEZA DE REPUESTO CORRECTA SEA SUMINISTRADA.

◆
 BEI DER BESTELLUNG VON ERSATZTEILEN BITTE DIE ERSATZTEILNUMMER, DAS HERSTELLUNGSDATUM UND DIE SERIENNUMMER DER PUMPE ANGEBEN.

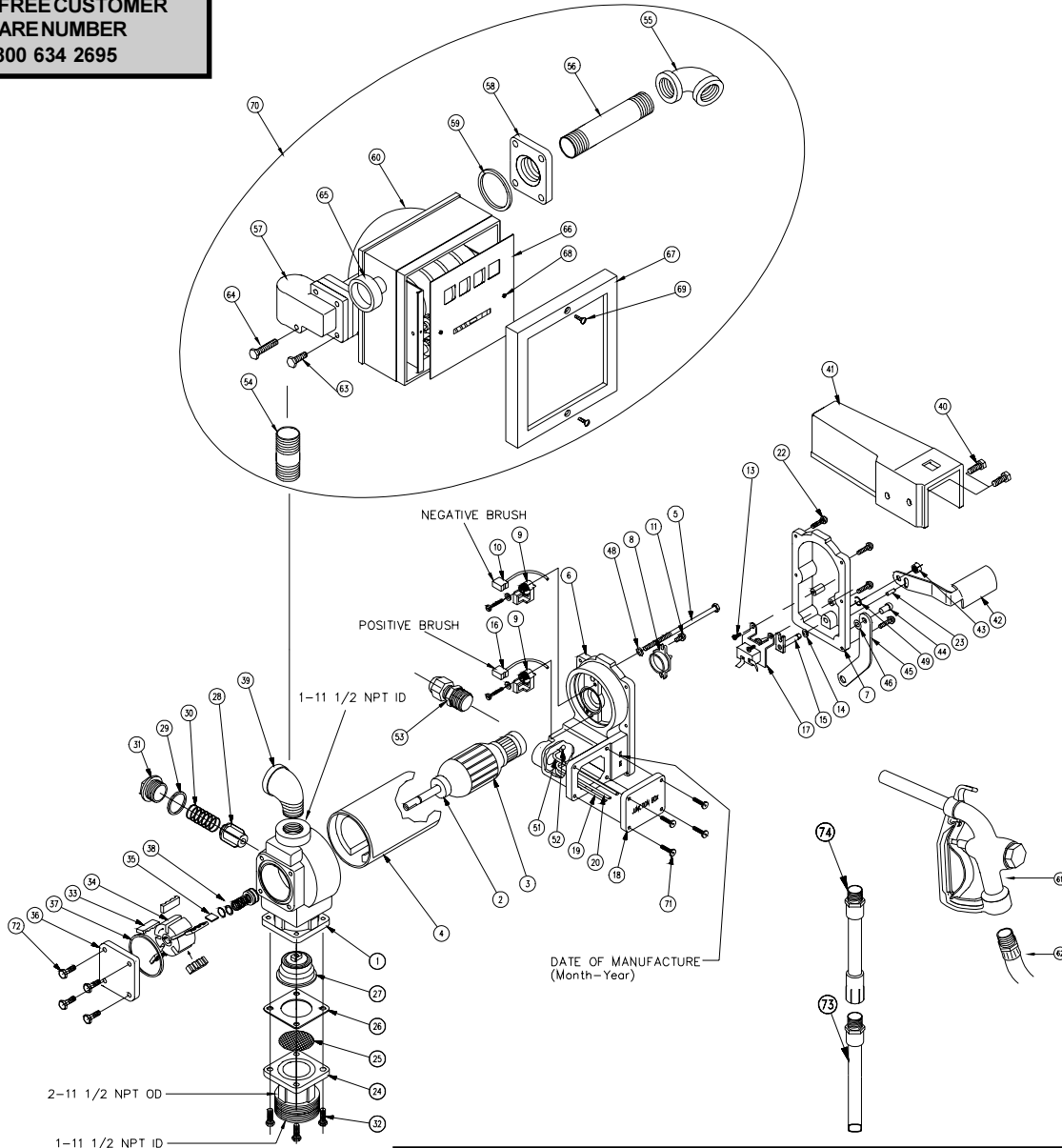

SERIES FR4200\FR4400 REPAIR KIT PART NO. 4200KTF8739
NÉCESSAIRE DE RÉPARATION DES SÉRIES FR4200/FR4400 N° RÉF 4200KTF8739
KIT DE REPARACIÓN, PIEZA No. 4200KTF8739, SERIE FR4200/FR4400
REPARATURSATZ FR4200\FR4400 BESTELL-NR. 4200KTF8739

Includes items • Comporte les articles • Inclulos ítemes • Einschliesslich lfd. Nr.
 25, 26, 28, 29, 33, 34, 35, 37, 38

ITM. NO.	PART NO.	DESCRIPTION	MATERIAL OF CONSTRUCTION	QTY
1	4200F7359	Pump Housing	Cast iron	1
2	1200F6545	Ball Bearing		2
3	4200F7696	Armature Assembly 12V (Includes Item 2)		1
	4400G7040	Armature Assembly 24V (Includes Item 2)		Opt.
4	1200F6526	Motor Frame and Magnet Assembly		1
5	1200F6475	1/4-20 x 5 Thru-Bolt		2
6	1200F7909	Motor Casting Assy. (Includes Items 19, 20, 51, 52)		1
7	1200F7396	Switch Plate with Bushing (Includes Items 23, 44, 45, 46)		1
8	1200F6645	Thermal Protector 12V		1
	VP1400F8848	Thermal Protector 24V		Opt.
9	1200F7239	Brush Holder Assembly		2
10	4200G7364	Brush Assembly, Negative		1
11	VP1400F8821	#8-32 x 1/2 Torx		1
13	VP1400F8820	#8-32 x 3/8 Torx		2
14	700F3167	5/16 Spring Washer		1
15	700F3149	Switch Shaft Assembly		1
16	4200G7363	Brush Assembly, Positive		1
17	4200F3305	Line Switch (FR4200)		1
	1200F3170	Line Switch (FR4400)		1
18	1200F6527	Junction Box Cover		1
19	1200F6668	Wire Lead- Neg./Black (Included with Item 6)		1
20	1200F6668	Wire Lead- Pos./Red (Included with Item 6)		1
22	VP1400F8823	10-24 x 3/4 Torx		6
23	1200F6650	5/32 x 1/2 Pin (Included with Item 7)		1
24	1200F6465	Inlet Flange	Cast iron	1
25	100F0760	Screen	Stainless steel	1
26	100F0790	Inlet Gasket	Cork/Buna-N	1
27	1200F6510	Check Valve Assembly	Acetal, fluorocarbon, zinc plated steel, stainless steel	1
28	1200F2756	Bypass Valve	Buna-N, polyester	1
29	1200F6455	Bypass Gasket (-121)	Buna-N	1
30	700F2775	Bypass Spring	Stainless steel	1
31	1200F6464	Bypass Cap	Steel	1
32	1200F6721	1/4-20 x 3/4 HHCS		4
33	4200F7365	Vane	Machined carbon	5
34	4200F7366	Rotor	Iron/copper	1
35	1200F6640	Rotor Key	Fiber	1
36	1200F6459	Rotor Cover	Steel	1
37	1200F6505	Rotor Cover Gasket (-138)	Buna-N	1
38	1200F6446	Seal Assembly	Viton, stainless steel, carbon, ceramic, brass	1
39	800F4400	1" Steel El	Galvanized steel	1
40	600F2220	5/16-18 x 3/4 HHCS		2
41	700F6688	Nozzle Cover		1
42	1200F6674	Switch Lever		1
43	700F2950	5/16 x 18 Locknut		1
44	600F1950	#14 x 5/8 Drive Screw (Type U) (Included with Item 7)		1
45	1200F6686	Locking Link (Included with Item 7)		1
46	5200F1440	1/4 Spring Washer (Included with Item 7)		1
48	785F8209	1/4 Ext. Lockwasher		2
49	700F3162	5/16 Retaining Ring		1
51	1200F6726	Ground Wire, Green (Included with Item 6)		1
52	1200F7342	#8-32 x 3/8 Ground Screw (Type F) (Included w/Item 6)		1
53	1200F7321	Cable Connector (Included w/Power Cable)		1
54	712F8002	1" x 2 3/4" Nipple	Galvanized steel	1
55	304F7885	1" 90° Elbow	Zinc plated steel	1
56	304F7924	1" x 5" Nipple	Zinc plated steel	1
57	305F0998	Meter Fitting	Cast iron	1
58	900F8076	Meter Flange	Cast iron	1
59	300F7744	O-Ring (-224)	Buna-N	2
60	900F8579	900 Meter Subassembly, Gallon		1
	900F8596	900 Meter Subassembly, Liter		Opt.
61	700F3125	1" Leaded Nozzle		1
	300F7801	1" Automatic Nozzle (Not Shown)		Opt.
62	304F7773	1" x 12' UL Listed Hose	Buna-N	1
63	1200F6721	1/4-20 x 3/4 HHCS		7
64	900F8649	1/4-20 x 2 HHCS		1
65	800F4261	Knob Assembly		1
66	900F8073	Meter Faceplate		1
67	900F8069	Meter Bezel		1
68	702F3410	#8-18 x 1/2 OHMS		2
69	800F4020	#4-40 x 1/4 PHMS		2
70	901MK4200	901 Meter Assembly, Gallon		1
	901LMK4200	901 Meter Assembly, Liter		Opt.
71	VP1400F8822	10-24 x .50 Torx		4
72	5200F1470	1/4-20 x.5 HHCS Zinc Grade 2		4
73	VP1400F7686	Suction Pipe	PVC	1
74	VP1400F7687	Suction Pipe Extension	PVC	2
	1200KTF7332	Cable (Not Shown)		1