

NPE STANDARD REPAIR PARTS LIST

Item No.	Description	Materials of Construction	1ST 1 x 1¼	2ST 1¼ x 1½	3ST 1½ x 2	QTY.
100	Casing	AISI 316L SS	1L81	1L82	1L83	1
101	Impeller		See Impeller chart on page 4			1
108A	Motor adapter with foot*		1L80	1		
108B	Motor adapter less foot*		1L87			
123	Deflector	BUNA-N		5K7		1
184A	Seal housing standard	AISI 316L SS		1L79	1	
184B	Seal housing with seal flush		1L333			
240	Motor support	300 SS		4L320	1	
	Rubber channel	Rubber		9K188	1	
304	Impeller locknut	AISI 316 SS		13K286	1	
347	Guidevane	AISI 316L SS	3L23	3L24	3L25	1
349	Seal ring, guidevane	Viton standard	5K269	5K270		1
		EPR	5K273	5K274		
		BUNA	5K271	5K272		
370	Socket head screw, casing	AISI 410 SS	13L65			8
371	Bolts, motor	Steel/plated	13K252			4
383	Mechanical seal		See Mechanical Seal Chart on Page 1			1
408	Drain and vent plug, casing	AISI 316 SS		6L3		2
412B	O-ring, drain plugs	Viton, standard		5L99	2	
		EPR		5L80		
		BUNA		5L62		
513	O-ring, casing	Viton standard		5K206	1	
		EPR		5K193		
		BUNA		5K4		
575	Pipe Cap	304 SS		6K150	1	

* Flush access hole provided.

NOTE:
OPTIONAL SEAL FLUSH COMPONENTS

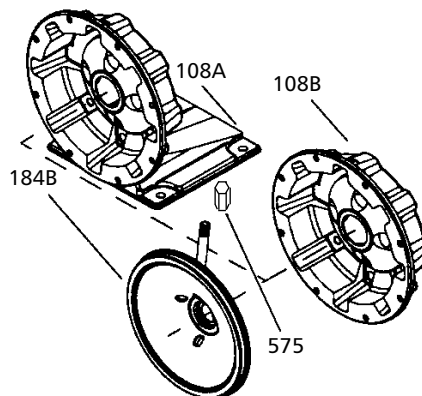

NOTE:

Close-coupled units using motors ½ – 1 HP (TEFC and ODP) will use footed motor adapter as standard.
 Close-coupled units using motors 1½ – 3 HP (TEFC and ODP) will use footless motor adapter as standard.
 Close-coupled units using motors 5 HP and all X-Proof will have a foot attached to the motor.

NOTE:

Frame mounted units (NPE-F) utilize the XS Power Frame and motor adapter less foot. For repair parts for the power frame refer to the XS-Power frame repair parts page in the parts section of your catalog. To order the power frame complete order item 14L61.

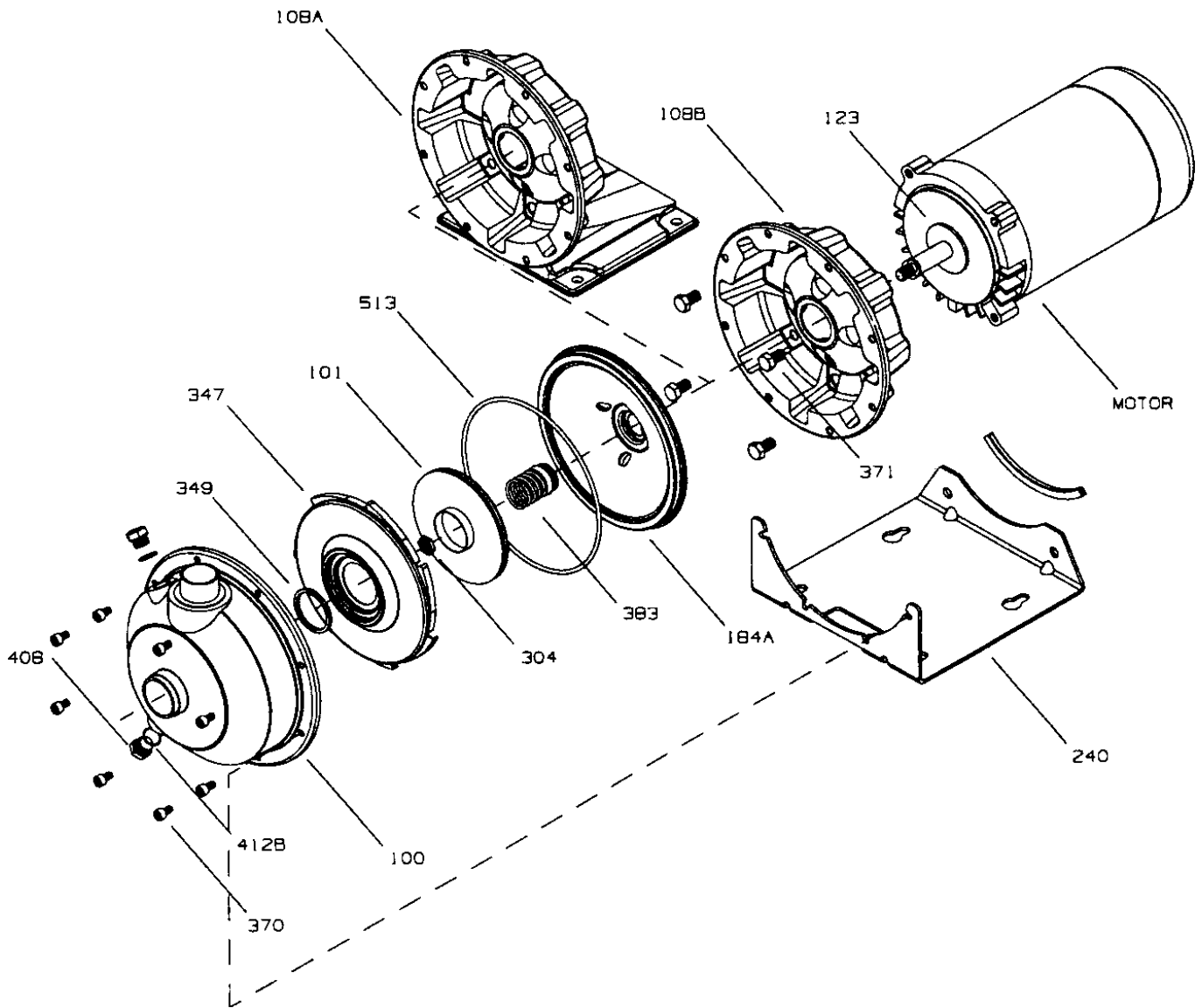

NPE STANDARD IMPELLERS

Impeller Code	Pump Size							
	1 x 1¼-6		1¼ x 1½-6		1½ x 2-6			
	Diameter	Part No.	Diameter	Part No.	Diameter	Part No.		
K			6⅞	2L885				
G			5⅞	2L700			5⅞	2L702
H			5½	2L699			5	2L701
A	6⅞	2L47	5¼	2L48	4¾	2L49		
B	5¾	2L44	5⅞	2L54	4⅞	2L58		
C	5⅞	2L46	4⅞	2L53	4⅞	2L57		
D	4¾	2L42	4⅞	2L52	4⅞	2L56		
E	4⅞	2L45	4¼	2L51	3⅞	2L55		
F	4⅞	2L59	3⅞	2L50				

NPE STANDARD IMPELLERS BY MOTOR SIZE AT 3500 RPM

For ODP/TEFC Units Built After September 1, 1997

HP	HP Code		1ST	2ST		3ST	
			ODP/TEFC	ODP/TEFC	ODP/TEFC		
½	C	Repair #	2L45				
		Dia.	4⅞				
		Imp. Code	E				
¾	D	Repair #	2L42	2L50			
		Dia.	4¾	3⅞			
		Imp. Code	D	F			
1	E	Repair #	2L46	2L51		2L55	
		Dia.	5⅞	4¼		3⅞	
		Imp. Code	C	E		E	
1½	F	Repair #	2L44	2L52		2L56	
		Dia.	5¾	4⅞		4⅞	
		Imp. Code	B	D		D	
2	G	Repair #	2L47	2L53		2L57	
		Dia.	6⅞	4⅞		4⅞	
		Imp. Code	A	C		C	
3	H	Repair #	2L47	2L48		2L49	
		Dia.	6⅞	5¼		4¾	
		Imp. Code	A	A		A	
5	J	Repair #			2L700	2L885	2L702
		Dia.			5⅞	6⅞	5⅞
		Imp. Code			G	K	G

For Current Explosion Proof and All Units Built Before September 1, 1997

HP	HP Code		1ST		2ST		3ST	
			ODP	TEFC/EXP	ODP	TEFC/EXP	ODP	TEFC/EXP
½	C	Repair #	2L45	2L59				
		Dia.	4⅞	4⅞				
		Imp. Code	E	F				
¾	D	Repair #	2L42	2L45	2L50			
		Dia.	4¾	4⅞	3⅞			
		Imp. Code	D	E	F			
1	E	Repair #	2L46	2L42	2L51	2L50	2L55	
		Dia.	5⅞	4¾	4¼	3⅞	3⅞	
		Imp. Code	C	D	E	F	E	
1½	F	Repair #	2L44	2L46	2L52	2L51	2L56	2L55
		Dia.	5¾	5⅞	4⅞	4¼	4⅞	3⅞
		Imp. Code	B	C	D	E	D	E
2	G	Repair #	2L47	2L44	2L53	2L52	2L57	2L56
		Dia.	6⅞	5¾	4⅞	4⅞	4⅞	4⅞
		Imp. Code	A	B	C	D	C	D
3	H	Repair #	2L47	2L47	2L48	2L54	2L49	2L58
		Dia.	6⅞	6⅞	5¼	5⅞	4¾	4⅞
		Imp. Code	A	A	A	B	A	B
5	J	Repair #			2L700	2L885		
		Dia.			5⅞	6⅞		
		Imp. Code			G	K		

Note:** Max. Explosion Proof rating is 2 HP.

NPE CLOSE-COUPLED MOTORS

MODEL NPE 3500 RPM

HP	Single-Phase, 60 Hz, 115/230 V**, 56J Frame								
	Open, Drip-Proof ^①			Totally Enclosed, Fan Cooled			Explosion Proof		
	Order No.	Max. Amps	Wt. (lbs.)	Order No.	Max. Amps	Wt. (lbs.)	Order No.	Max. Amps	Wt. (lbs.)
1/2	E04853S	10.0/5.0	16	E04821	6.2/3.1	21	BBC04825	6.2/3.1	47
3/4	E05853S	14.0/7.0	19	E05821	8.8/4.4	24	BBC05825	8.8/4.4	41
1	E06853S	16.0/8.0	22	E06821	11.6/5.8	26	BBC06825	11.6/5.8	49
1 1/2	E07858S	21.4/10.7	31	E07821	16.2/8.1	35	BBC07825	16.2/8.1	56
2	E08854	26.8/13.4	36	E08821	20.8/10.4	39	BBC08825	20.8/10.4	60
3	E09854	14.0	40	E09821	11.89	44			
5	E10754	14.4	55						

Note:** 3 and 5 HP Single-Phase motors are 230 V only.

HP	Three-Phase, 60 Hz, 208-230/460 V, 56J Frame								
	Open, Drip-Proof ^①			Totally Enclosed, Fan Cooled			Explosion Proof		
	Order No.	Max. Amps	Wt. (lbs.)	Order No.	Max. Amps	Wt. (lbs.)	Order No.	Max. Amps	Wt. (lbs.)
1/2	E04873	2.6/1.3	19	E04876	1.9/.95	18	BBC04875	1.9/.95	27
3/4	E05873	3.4/1.7	19	E05876	2.3/1.15	21	BBC05875	2.3/1.15	30
1	E06873	4.2/2.1	22	E06876	3.2/1.6	21	BBC06875	3.2/1.6	30
1 1/2	E07878	5.8/2.9	25	E07876	4.8/2.4	27	BBC07875	4.8/2.4	37
2	E08874	6.9/3.3	39	E08876	5.4/2.7	33	BBC08875	5.4/2.7	44
3	E09874	7.2/3.6	31	E09876	7.6/3.8	37			
5	E10774	7.2/14.4	50	E10876	6.2/12.4	48			

① For vertical mounting order motor canopy separately - 9K272 for 1/2, 3/4 and 1 HP single phase or 9K273 for all other ODP motors.

MODEL NPE 1750 RPM

HP	Single-Phase, 60 HZ, 115/230 V, 56J Frame								
	Open, Drip-Proof ^①			Totally Enclosed, Fan Cooled			Explosion Proof		
	Order No.	Max. Amps	Wt. (lbs.)	Order No.	Max. Amps	Wt. (lbs.)	Order No.	Max. Amps	Wt. (lbs.)
1/2	E04811	8.6/4.3	19	E04812	8.0/4.0	20	BBC04815	8.0/4.0	45

HP	Three-Phase, 60 HZ, 208-230/460 V, 56J Frame								
	Open, Drip-Proof ^①			Totally Enclosed, Fan Cooled			Explosion Proof		
	Order No.	Max. Amps	Wt. (lbs.)	Order No.	Max. Amps	Wt. (lbs.)	Order No.	Max. Amps	Wt. (lbs.)
1/2	E04831	3.76/4.0/2.0	20	E04832	1.77/1.6/.8	20	BBC04835	1.77/1.6/.8	45

Note: Explosion Proof Motors are class 1 and 2, Group D