

HydroMinder Model 511 Parts Diagram/List

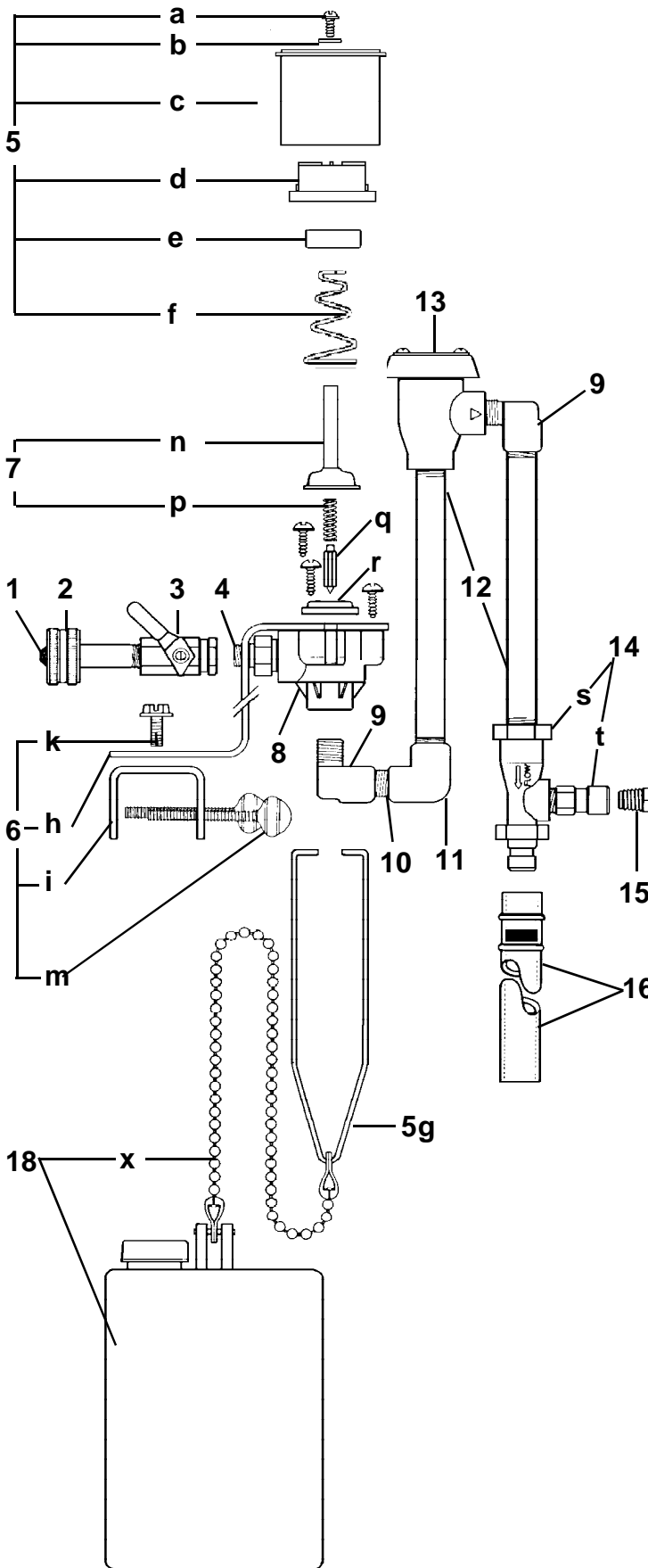

| KEY | PART NO. | DESCRIPTION |
|-----|----------|--|
| 1 | 238100 | strainer washer |
| 2 | 506500 | hose swivel |
| 3 | 502000 | ball valve |
| 4 | 360900 | nipple |
| 5 | 10080500 | magnet parts kit |
| a. | | screw |
| b. | | washer |
| c. | | magnet cover |
| d. | | magnet cap |
| e. | | magnet |
| f. | | magnet spring |
| g. | | magnet yoke |
| 6 | 5030-K | mounting bracket kit (specify model 511) |
| h. | | Z bracket |
| i. | | U clamp |
| j. | | lockwasher (not shown) |
| k. | | screw |
| m. | | thumbscrew |
| 7 | 665520 | valve parts kit |
| n. | | valve guide ("bonnet") |
| p. | | armature spring |
| q. | | armature |
| r. | | diaphragm |
| 8 | 520000 | water valve body |
| 9 | 505600 | street elbow |
| 10 | 519000 | close nipple, 1/4" |
| 11 | 506000 | elbow |
| 12 | 505900 | nipple, 6" |
| 13 | 506300 | vacuum breaker |
| 14 | 440121 | eductor assembly |
| | 440100 | s. eductor body only |
| | 440101 | t. suction stub only |
| 15 | 690015 | metering tip (kit) |
| 16 | 5057-A | discharge tube assembly |
| 17 | 5058-9A | suction tube assembly |
| | 505809 | u. tubing, 1/2" x 9' |
| | 250006 | v. ceramic weight |
| | 10076301 | w. foot valve, Viton |
| | 250700 | (foot valve & weight) |
| 18 | 5043-A | float & chain assembly |
| | 507200 | x. bead chain only |