

All 9303C and 9303S Series Pumps

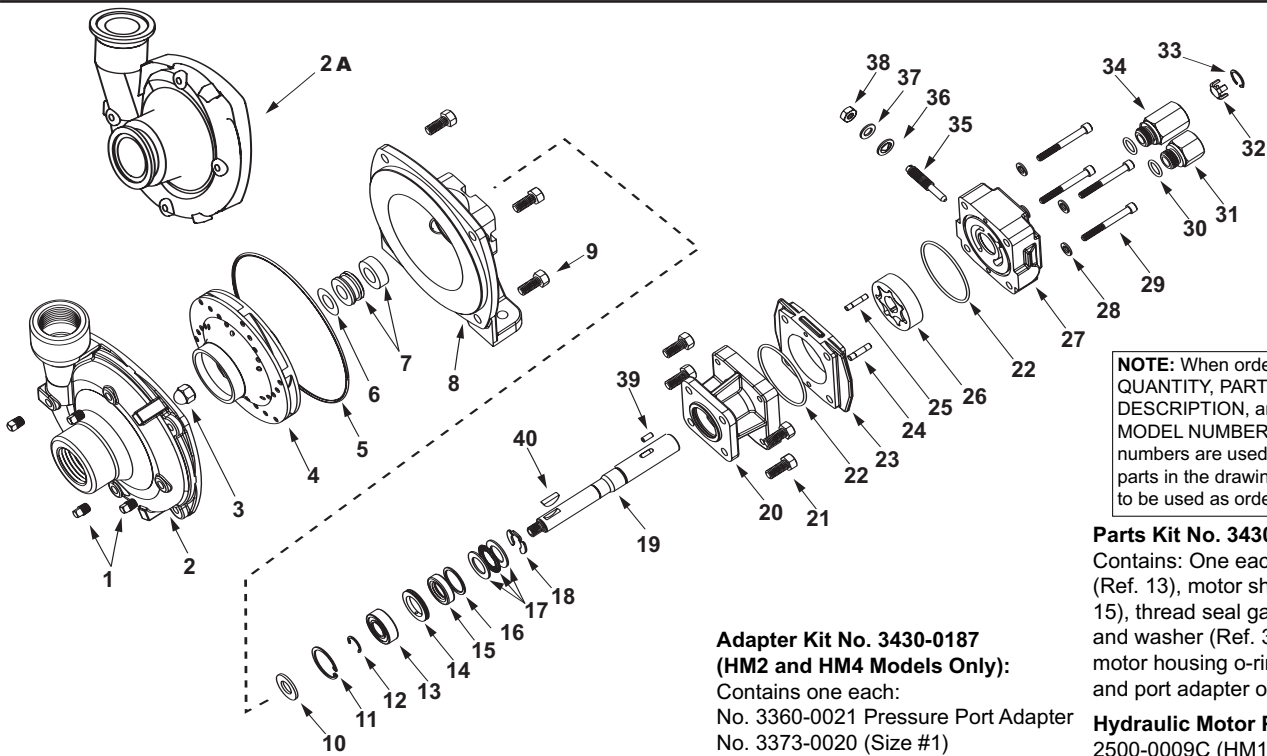

NOTE: When ordering parts, give QUANTITY, PART NUMBER, DESCRIPTION, and COMPLETE MODEL NUMBER. Reference numbers are used ONLY to identify parts in the drawing and are NOT to be used as order numbers.

Repair Parts Kit No. 3430-0332

Contains: One o-ring (Ref. 5), one rubber gasket (Ref. 6), and one mechanical seal (Ref. 7).

Silicon Seal Kit No. 3430-0589

Contains one each: 1720-0083 o-ring (Ref. 5) and one mechanical seal (silicon carbide) (Ref.7).

Adapter Kit No. 3430-0187 (HM2 and HM4 Models Only):

Contains one each:
 No. 3360-0021 Pressure Port Adapter
 No. 3373-0020 (Size #1)
 No. 3373-0021 (Size #2)
 No. 3373-0022 (Size #3).
 No. 1720-0108 Adapter O-ring and
 No. 1720-0105 Orifice O-ring (Qty 3).

Parts Kit No. 3430-0178

Contains: One each ball bearing (Ref. 13), motor shaft seal (Ref. 15), thread seal gasket (Ref. 36), and washer (Ref. 37); two each motor housing o-rings (Ref. 22), and port adapter o-rings (Ref. 30).

Hydraulic Motor Part Nos.

2500-0009C (HM1C Models)
 2500-0010C (HM2C Models)
 2500-0011C (HM3C Models)
 2500-0012C (HM4C Models)
 2500-0018C (HM5C Models)

| Ref. No. | Qty. Req'd. | Part No. | Description |
|----------|-------------|-------------|--|
| 1 | 4 | 2406-0007 | Drain/Vent Plug (9303C) |
| 1 | 4 | 2406-0016 | Drain/Vent Plug (9303S) |
| 2 | 1 | 0150-9000C | Pump Casing (Model 9303C) |
| 2 | 1 | 0150-9000S | Pump Casing (Model 9303S) |
| 2A | 1 | 0153-9000C | Pump Casing (Universal Flange) |
| 3 | 1 | 2253-0002 | Impeller Nut (9303C) |
| 3 | 1 | 2253-0006 | Impeller Nut (Model 9303S) |
| 4 | 1 | 0401-9100P | Impeller (Nyglass, std.)(9303C) |
| 4 | 1 | 0402-9100P | Impeller (Optional Polypropylene) (Std 9303S) |
| 5 | 1 | 1720-0083 | O-ring |
| 6 | 1 | 1700-0100 | Rubber Gasket (9303C) |
| 7 | 1 | 2120-0009 | Mechanical Seal (Viton/Ceramic) (Std 9303C) |
| 7 | 1 | 3430-0589 | Mechanical Seal (Silicon Carbide) (Std 9303S) |
| 8 | 1 | 0750-9300C | Mounting Flange |
| 8 | 1 | 0756-9300S | Mounting Flange (Model 9303S) |
| 9 | 4 | 2210-0020 | Hex Head Cap Screw (9303C) |
| 9 | 4 | 2210-0125 | Hex Head Cap Screw (Model 9303S) |
| 10 | 1 | 1410-0056 | Slinger Ring |
| 11 | 1 | 1820-0013 | Retaining Ring |
| 12 | 1 | 1810-0014 | Snap Ring |
| 13 | 1 | 2000-0010 | Ball Bearing |
| 14 | 1 | 1410-0073 | Spacer |
| 15 | 1 | 2104-0005 | Shaft Seal |
| 16 | 1 | 1410-0074 | Seal Spacer |
| 17 | 1 | 2029-0014 | Thrust Bearing Assembly—Consists of: (1) Thrust Bearing & (2) Thrust Brg. Races |
| 18 | 1 | 1810-0026 | Snap Ring |
| 19 | 1 | 0509-2500 | Shaft (HM2C & HM4C Models) 6-3/4" Long |
| 19 | 1 | 0511-2501 | Shaft (HM1C & HM5C Models) 7" Long |
| 19 | 1 | 0510-2500 | Shaft (HM3C Models) 7 -1/2" Long |
| 20 | 1 | 0151-2500C | Motor Body (Includes Main Bearing) |
| 21 | 4 | 2210-0005 | Hex Head Cap Screw |
| 22 | 2 | 1720-0110 | O-ring |
| 23 | 1 | 0701-2500C1 | Gerotor Housing (HM2C Models) 1/4" Wide |

| Ref. No. | Qty. Req'd. | Part No. | Description |
|----------|-------------|-------------|--|
| 23 | 1 | 0700-2500C1 | Gerotor Housing (HM1C Models) 1/2" Wide |
| 23 | 1 | 0703-2500C1 | Gerotor Housing (HM4C Models) 5/16" Wide |
| 23 | 1 | 0702-2500C1 | Gerotor Housing (HM3C Models) 1" Wide |
| 23 | 1 | 0704-2500C1 | Gerotor Housing (HM5C Models) 5/8" Wide |
| 24 | 1 | 1600-0045 | Dowel Pin (HM2C & HM4C Models) |
| 24 | 1 | 1600-0044 | Dowel Pin (HM1C & HM5C Models) |
| 24 | 1 | 1600-0052 | Dowel Pin (HM3C Models) |
| 25 | 1 | 1600-0042 | Dowel Pin (HM2C & HM4C Models) |
| 25 | 1 | 1600-0037 | Dowel Pin (HM1C & HM5C Models) |
| 25 | 1 | 1600-0068 | Dowel Pin (HM3C Models) |
| 26 | 1 | 3900-0022 | Gerotor (HM1C Models) |
| 26 | 1 | 3900-0023 | Gerotor (HM2C Models) |
| 26 | 1 | 3900-0024 | Gerotor (HM3C Models) |
| 26 | 1 | 3900-0025 | Gerotor (HM4C Models) |
| 26 | 1 | 3900-0048 | Gerotor (HM5C Models) |
| 27 | 1 | 0251-2500C2 | Motor End Plate (Includes Main Bearing) |
| 28 | 4 | 2270-0039 | Washer |
| 29 | 4 | 2220-0045 | Cap Screw (HM2C & HM4C Models) |
| 29 | 4 | 2220-0021 | Cap Screw (HM1C) |
| 29 | 4 | 2220-0044 | Cap Screw (HM3C Models) |
| 29 | 4 | 2220-0032 | Cap Screw (HM5C) |
| 30 | 2 | 1720-0108 | O-ring |
| 31 | 1 | 3360-0021 | Pressure Port Adapter |
| 32 | 1 | 3260-0068 | Poppet |
| 33 | 1 | 1820-0038 | Retaining Ring |
| 34 | 1 | 3320-0049 | Tank Port Adapter |
| 35 | 1 | 3220-0029 | Bypass Adjusting Screw |
| 36 | 1 | 1700-0047 | Gasket |
| 37 | 1 | 2270-0027 | Washer |
| 38 | 1 | 2250-0038 | Lock Nut |
| 39 | 1 | 1610-0032 | Roll Pin (HM2C & HM4C Models) |
| 39 | 1 | 1610-0031 | Roll Pin (HM1C & HM5C Models) |
| 39 | 1 | 1610-0055 | Roll Pin (HM3C) |
| 40 | 1 | 1610-0012 | Woodruff Key (9303C) |
| 40 | 1 | 04432 | S.S. Woodruff Key (Model 9303S) |