

"T" Series PACER Pumps

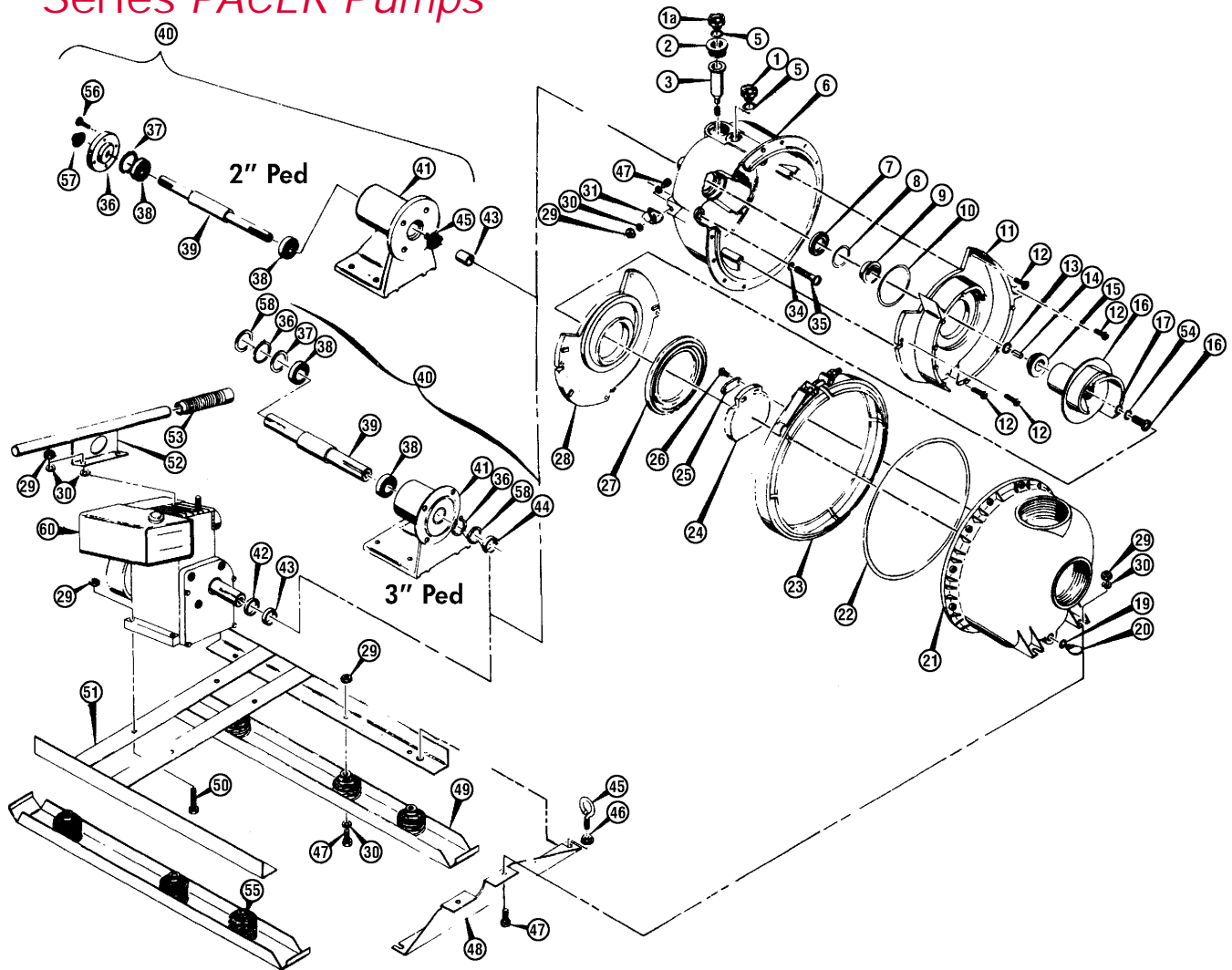

Item No.	Pump Size	Part No.	Description	Qty.
1		58-0722 30B	Plug, filler, black	1
1A		58-0722 30A	Plug, filler, oil lube, red	1
2		58-46294 30	Retainer, lube tube	1
3		58-46215 71	Tube, lubrication seal, buna-N	1
5		58-0765 71	O-Ring, filler plug, buna-N	2
6	2"	58-46218 31A	Bracket, assembly, includes items 1, 1A, 2, 3, 5, 6, 7, 8, 9	1
	3"	58-46208 31A	Bracket, assembly, includes items 1, 1A, 2, 3, 5, 6, 7, 8, 9	1
7	2"	58-46314 11	Seal, oil lip	1
	3"	58-46313 11	Seal, oil lip	1
8	2"	58-0976 71	O-ring, shaft seal, buna-N	1
	3"	58-46307 71	O-ring, shaft seal, buna-N	1
9&15	2"	58-46250 11	Seal, shaft, stainless steel/silicon carbide/buna-N	1
	3"	58-46251 11	Seal, shaft, stainless steel/silicon carbide/buna-N	1
10	2"	58-1203 71	O-ring, volute, buna-N	1
	3"	58-46292 71	O-ring, volute, buna-N	1
11	2"	58-46224 80	Volute, urethane coated with steel core	1
	3"	58-46204 80	Volute, urethane coated with steel core	1
12	2"	58-46269 10	Screw, Btn. Hd. 1/4" - 20 x 1", stainless steel	2
	3"	58-4269 10	Screw, Btn. Hd. 1/4" - 20 x 1", stainless steel	4
13	2"	58-0778 11	Shim, impeller, .006" thick, stainless steel	As req'd.
	2"	58-0778 12	Shim, impeller, .015" thick, stainless steel	As req'd.
	2"	58-0778 13	Shim, impeller, .030" thick, stainless steel	As req'd.
	3"	58-46338 10	Shim, impeller, .015" thick, stainless steel	As req'd.
14	2"	58-46339	Key, 3/16" square x 11/16" long	1
	3"	58-46278	Key, 1/4" square x 1" long	1
16	2"	58-46229 80	Impeller, urethane coated with steel core	1
	2"	58-46229 81	Impeller, same as above but with silicon carbide seal half installed	1
	3"	58-46214 80	Impeller, urethane coated with steel core	1
	3"	58-46214 81	Impeller, same as above but with silicon carbide seal half installed	1

"T" Series PACER Pumps

Item No.	Pump Size	Part No.	Description	Qty.
17	2" 3"	58-46291 71 58-46290 71	O-ring, impeller screw, buna-N O-ring, impeller screw, buna-N	1 1
18	2" 3"	58-0715 10 58-46309 10	Screw, impeller, 5/16" - 24 x 1-1/4" stainless steel Screw, impeller, 7/16" - 20 x 1-1/4" stainless steel	1 1
19		58-1009 71	O-ring, drain plug, buna-N	1
20		58-0723 30	Plug, drain	1
21	2" 3"	58-46252 31A 58-46207 31A	Body, assy., includes items 19-20, 24-27 and the body (front housing) Body, assy., includes items 19-20, 24-27 and the body (front housing)	1 1
22		58-46304 71	O-ring, body, buna-N	1
23		58-46305 10	Clamp, V-band, stainless steel	1
24		58-46217 71	Valve, check, buna-N	1
25		58-46344 30	Retainer, check valve, polyester	1
26		58-1348 10	Screw, check valve retainer, #10-14 x 3/4", self-tapping, stainless steel	2
27		58-46206 71	Gasket, suction, buna-N	1
28	2" 3"	58-46225 91 58-46205 91	Wearplate, rubber coated with steel core Wearplate, rubber coated with steel core	1 1
29	2"&3"	58-0745	Nut, keps, 5/16" - 18, plated steel	15
30		58-0730	Washer, flat, 5/16", plated steel, Engine drive only	14
31		58-46274	Holder, spanner wrench	1
32		58-0729	Screw, wrench holder, 5/16" - 18 x 1"	1
34	2" 3"	58-0717 71 58-46303 71	O-ring, bracket screw, buna-N O-ring, bracket screw, buna-N	4 4
35	2" 3"	58-0715 10 58-46308 10	Screw, bracket, 5/16" - 18 x 1-1/4" stainless steel/ engine drive/pedestal mount Screw, bracket, 3/8" - 16 x 1-1/2" stainless steel/ engine drive/pedestal mount	4 4
36	2" 3"	58-1953 10 58-46354 90	End Plate, stainless steel Ring, snap, retaining	1 2
37	2" 3"	58-1956 10 58-46353 10	Shim, stainless steel Shim, stainless steel	As needed As needed
38	2" 3"	58-1954 90 58-46352 90	Bearing Bearing	2 3
39	2" 3"	58-1952 10 58-46346 10	Shaft 3/4" diameter, stainless steel Shaft 1" x 1-1/8" diameter, stainless steel	1 1
40	2" 3"	58-1950 03 58-46350 02	Pedestal Assy. includes items 36-39, 41, 43, 56-57 (3/4" shaft) Pedestal Assy. includes items 36-39, 41, 43, 56-57 (1" shaft)	1 1
41	2" 3"	58-1951 90 58-46345 90	Housing, bearing pedestal for 3/4" shaft Housing, bearing pedestal for 1" shaft	1 1
42	2" 3"	58-0884 71 48-46266 71	Slinger, for 3/4" shaft Slinger, for 1" shaft	1 1
43	2"	58-46219 10	Sleeve, for 3/4" shaft, stainless steel	1
44	3"	58-46359 10	Sleeve, for 1" shaft, stainless steel	1
45&46		58-46282 01	Bolt, eye and nut assembly	2
47		58-0729	screw, 5/16" - 18 x 1", plated	8
48	2" 3"	58-46306 58-46302	Support, front housing, 17" long Support, front housing, 18-7/16" long	1 1
49	3" 2"	58-46331 01 58-46315 01	Skid Assy. includes mounted springs Skid Assy. includes mounted springs	2 2
50		58-2167	Screw, engine to chassis, 5/16" - 18 x 1-1/2"	4
51	2" 3"	58-46310 58-46347	Chassis, weldment Chassis, weldment	1 1
52	3"	58-46268	Handle, weldment	1
53		58-46267 90	Grip, handle	2
54	2" Only	58-46341	Washer, impeller screw, rubber coated	1
55		58-46317	Spring, plated	6
56	2"	58-2525 10	Screw, hex, 1/4" - 20 x 3/4", stainless steel	4
57	2"	58-1955 71	Lip seal, buna-N	2
58	3"	58-46216 71	Shaft, slinger/washer, buna-N	2
59	2" 3"	58-1896 50 58-1897 50	Spanner, wrench, engine drive only Spanner wrench, engine drive only	1 1
60	2" 3"	58-0635 A 58-0648 A	Engine, B&S, 5 HP, 1/C Recoil Start Engine, B&S, 8 HP, 1/C Recoil Start	1 1

† Quantity per pump is based upon an engine driven pump mounted on spring isolated base rails. Other models may require fewer of certain incidental parts such as screws, washers, etc.