

2950 Series with Offset Shank *Yetter*

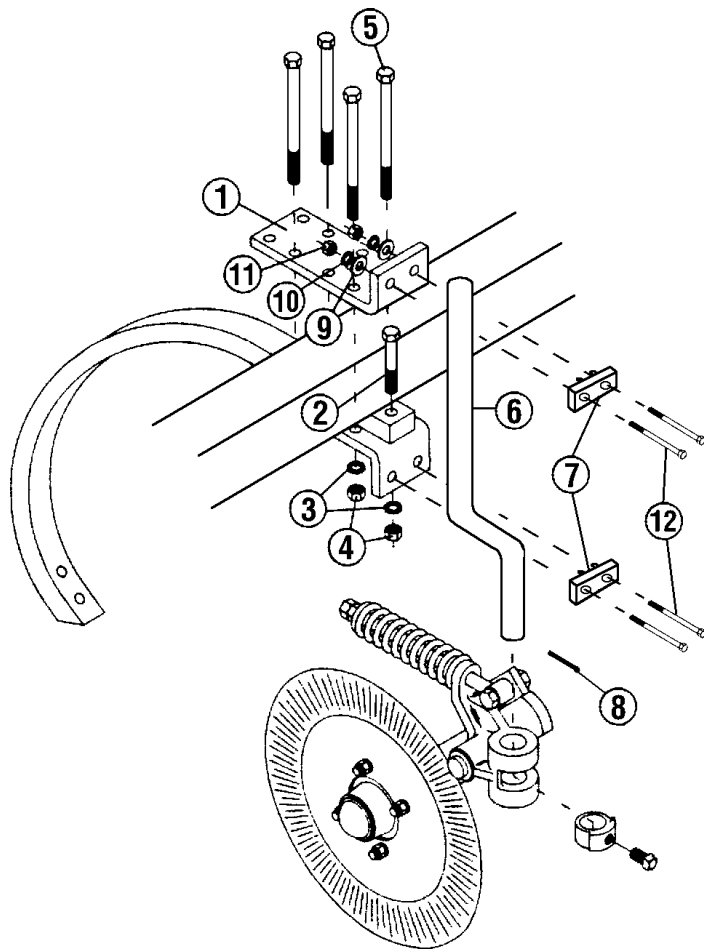

Installation & Operating Instructions:

The 2950 Offset Disc Chisel couler is designed with two mounting arrangements in mind. The bracket assembly can be attached to the frame beside existing shank brackets or can replace the shank brackets. Before beginning to assemble, choose the method need and follow instructions for that method.

Installing New Brackets: Before assembling the brackets, mark your bar for the spacing of the coulters. Select parts numbered 3010-301, 2525-451, 2520-452 and 2502-394 and mount them loose on the bar as shown. If installing a chisel or coil shank, slide it under the tool bar and bolt to bottom shank bracket with 5/8" -11 x 3-1/4" bolt (2502-385) and 5/8" nuts and washers. Align the brackets on the marks on the tool bar and tighten. (Be sure brackets remain square with the bar to assure shank will be straight when installed.) Offset shank can now be installed (see below).

Installing Beside Existing Brackets: If mounting brackets next to existing brackets, select part numbers 3010-301, 2525-451, 2520-452 and 2502-395 and mount as shown. Slide the assembly as close as possible to the existing brackets and tighten 5/8" bolts and nuts. Offset shank can now be installed (see below).

Installing Offset Shank: Install clamp weld assemblies (3011-201) into shank brackets using the 1/2" flatwashers, lockwashers, nuts an 4" bolts (leave the clamp weld assemblies loose to allow shank to go through the assembly). Raise the shank up through the bottom until shank is through both clamp weld assemblies. Set the shank at the proper depth and tighten the 1/2" nuts and bolts.

Before going to the field, all coulters should first be set to operate at the same depth. To adjust the depth of each couler, the clamp w.a. holding the 1-1/2" shank must be loosened. The 1-1/2" shank can then be slipped up or down to give the desired depth and/or clearance. At this time turn the offset shank to position the couler in front of the chisel or coil shank. (NOTE: The depth of the coulters should be set so the hub of each couler is always about ground level when in use.

Ref. No.	Part No.	Description	Qty.
1	3010-301	Shank bracket (red)	2
	3010-305	Shank bracket (3 Pt. special)	2
	3010-306	Shank bracket 5x7, 7x7 bar	2
	2950-300	No Till shank bracket	2
2	2525-451	5/8" med. lockwasher zp.	4
3	2520-452	5/8" - 11 hex. nut zp.	4
4	2502-395	5/8" - 11 x 6-1/2" hex hd. capscrew gr. 5 zp.	4
	2502-394	5/8" - 11 x 8" hex hd. capscrew gr. 5 zp.	4
	2502-333	5/8" - 11 x 9" hex hd. capscrew gr. 5 zp.	4
5	3011-302	Offset couler shank, 5-1/2	1
6	3011-201	Clamp W. A.	2
7	2530-208	3/8" x 2-1/2" Roll pin zp.	2
8	2526-351	1/2" Std. Flatwasher zp.	4
9	2525-352	1/2" med. lockwasher zp.	4
10	2520-352	1/2" - 13 hex nut zp.	4
11	2502-364	1/2" - 13 x 4" hex hd. capscrew gr. 5 zp.	4