

GREEN GARDE

Model JD9-C / JD9-CT Spray Guns

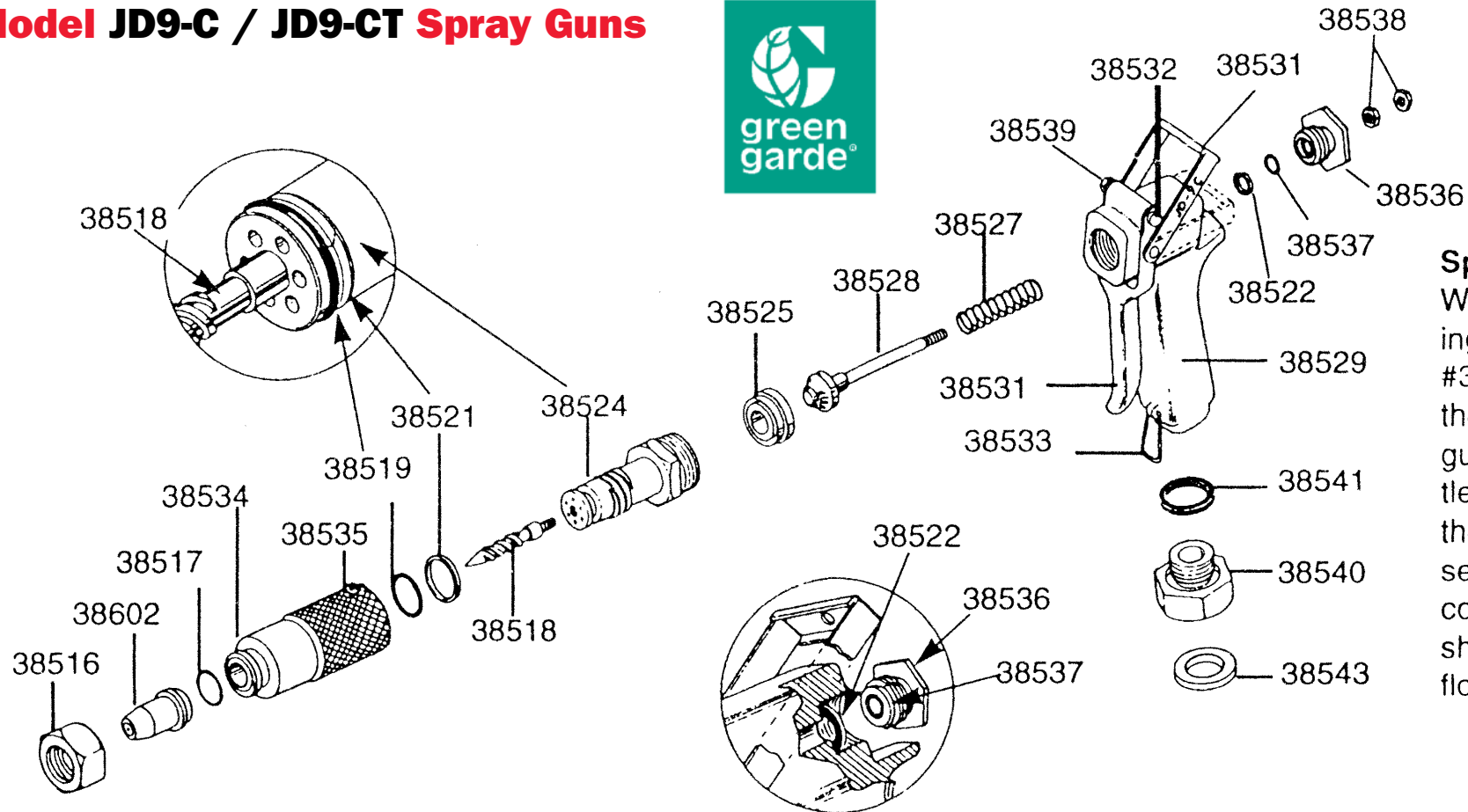

Special Note:
When tightening the two #38538 Nuts at the rear of the gun, allow a little slack so that the valve will seat properly, completely shutting off the flow.

Part No.	Description
38516	Cap
38517	O-ring
38518	Whirler
38519	O-Ring
38521	Back up ring
38522	Gland Packing
38524	Adjuster Body
38525	Teflon Valve Seat
38527	Valve Spring

Part No	Description
38528	Stainless Steel Valve
38529	Grip (38530 tapped for gauge)
38531	Trigger Assembly
38532	Bolt, Stainless Steel
38533	Stopper Clip
38534	Adjuster Nut (barrel)
38535	Screw for adjuster nut
38536	Gland
38537	O-ring

Part No.	Description
38538	Nut (2)
38539	Locking Nut
38540	3/4" Garden Hose Coupling
38541	Special Packing Gasket
38543	Garden Hose Washer
38544	Plug for Gauge (38501 gun only NOT ILLUSTRATED)
38602	Nozzle Tip & Retainer